

PART NUMBER: RPA-50

FREQUENCY RANGE	ATTENUATION ACCURACY (dB)		VSWR (max.)
	DC-1GHz	1-2 GHz	
DC - 2 GHz	±0.3	±0.5	1.15:1 DC to 1.0 GHz
			1.25:1 1.0 to 2.0 GHz

50 WATTS (500 watts peak)

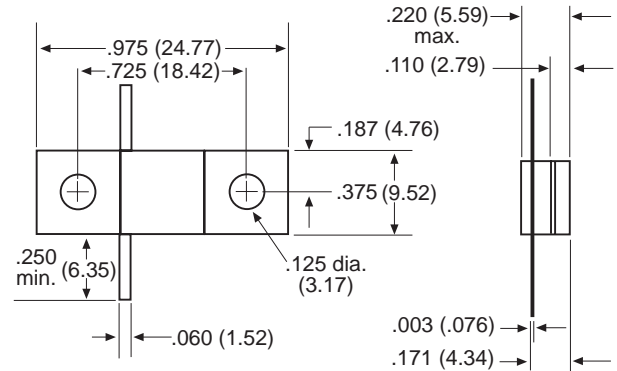

1 to 20 dB

PART NUMBER: RPA-125

FREQUENCY RANGE	ATTENUATION ACCURACY (dB)				VSWR (max.)
	dB	DC-1GHz	1-2 GHz	2-3 GHz	
DC - 3 GHz	1 - 10	±0.3	±0.4	±0.6	1.15:1 DC to 1.0 GHz
	11 - 20	±0.4	±0.6	±0.75	1.20:1 1.0 to 2.0 GHz
	21 - 30	±0.5	±0.75	N/A	1.25:1 2 to 3.0 GHz

125 WATTS (1000 watts peak)

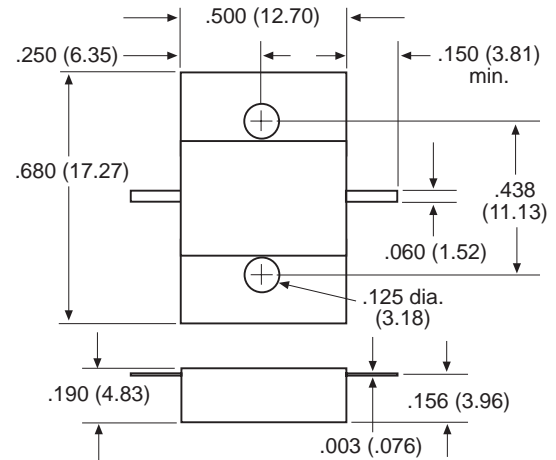

1 to 30 dB

PART NUMBER: RPA-200

FREQUENCY RANGE	ATTENUATION ACCURACY (dB)		VSWR (max.)	
	dB	DC-.5 GHz		.5-1 GHz
DC - 1 GHz	1 - 10	±0.3	±0.5	1.15:1 DC to 1.0 GHz
	11 - 20	±0.3	±0.75	
	21 - 30	±0.3	±1.0	

180 WATTS (900 watts peak)

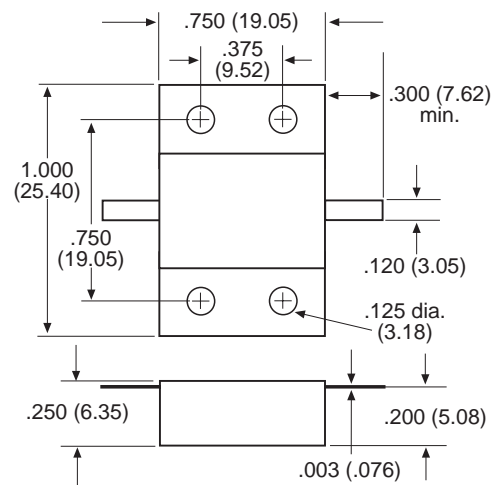

1 to 30 dB